

Product data sheet H600

With a Hydraloop device, you can recycle up to 95% of shower, handbasin & bath greywater and optionally 50% of washing machine greywater – which enables you to reuse 25 to 45% of the total in-house domestic water. Through innovative and breakthrough technology, Hydraloop recycled water is clean, clear, safe and certified and can be reused for toilet flushing, washing machine, garden irrigation and/or swimming pool top-up.

Hydraloop H600 has been tested and certified to NSF/ANSI 350 and IAPMO R&T.

Hydraloop H600

H600	Input: Greywater from shower, bath, washing machine, condensate drain Output: Three (3) valves for reusable water to the toilets, washing machine and auxiliary* use. Colour: Ivory Front plate: Galvanised steel front plate with top status light Front plate design cover**: Magnetic design cover with various prints
-------------	--

* Auxiliary outlet is always present, but to activate must be ordered as add-on

** Design cover is an optional magnetic full color cover, available as add-on

Output specifications

The recycled water from Hydraloop is suitable for toilet flushing, washing machine, garden irrigation, topping up swimming pool and cleaning purposes.

Output Outlet	Water Delivery	Pipe size
Toilet (WC)	permanently pressurized	1/2" BSP
Washing machine (WM)	permanently pressurized	1/2" BSP
Auxiliary (AUX) *	only pressurized before transfer to T3 when T3 is full	1/2" BSP

* Auxiliary outlet will be activated after order as add-on.

Distribution pump performance:

- Nominal pump pressure: 2.1 bar / 210 kPa
- Nominal flow: 12 l/min



Input specifications

Hydraloop requires a backup water connection in case there is insufficient recycled water available. Backup water can be mains (tap) water, treated rainwater or treated well water.

Input Outlet	Water Delivery	Pipe size
Backup water	permanently pressurized min. 12 l/min required	1/2" BSP

The backup water enters the Hydraloop via a safe air gap (T4), ensuring no possible connection between (recycled) grey water and backup water.

Specifications

Hydraloop H600	
Volume	600 liters
Nominal cleaning capacity	850 liters (depending on user behavior)
Voltage	120 / 240V, 24V internal
Average power consumption	460 kWh/year, 53W during treatment
Internet	The Hydraloop device needs to be connected with internet via: Ethernet cable or; 2.4 GHz Wi-Fi with WPA or WPA2, no captive portal. If internet access is restricted by a firewall, ensure TCP port 443 is open. Distance Wi-Fi router to Hydraloop > 1 m.
Greywater input sources (possible)	Shower, Bath, Washing machine *, and Condensate from air-conditioning, heat pump or tumble dryer



Sound Pressure (Lpa) level at various treatment stages		Interval / duration
Air pump	29 dB(A)	Daily / long
Distribution pump	29 dB(A)	Daily / with use
Greywater flow into Hydraloop	49 dB(A)	Daily / with use
Backup water filling	48 dB(A)	Weekly / depending on user behavior
Inlet diverter open/close	50 dB(A)	Depending on user behavior / when recycling greywater from washing machine
Self-cleaning cycle	50 dB(A)	Weekly / short

* When collecting greywater from washing machine, you must supply recycled water to the washing machine from the 'WM' outlet.

Dimensions and weights

HYDRALOOP MODEL	WIDTH (MM)	DEPTH (MM)	HEIGHT (MM)	DRY WEIGHT (KG)	WET WEIGHT (KG)
H600	800	695	2080	128	740
H600 PACKAGED	705	820	2190	138	—

For the technical detailed drawing, see the next page.

PVC ball valve - Position options

a. Horizontal option



b. Vertical option



Two Inlet options have been provided : 50mm standard or 40mm with the supplied ball valve.

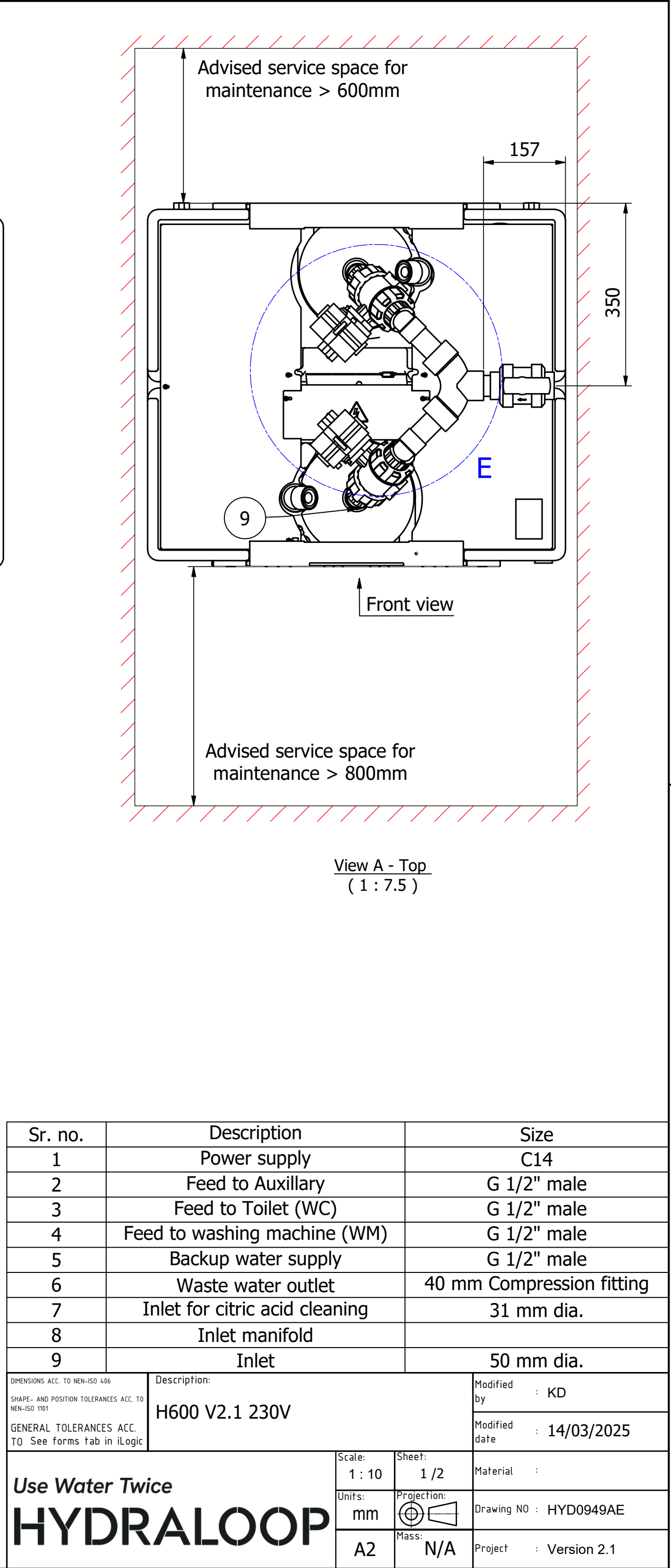
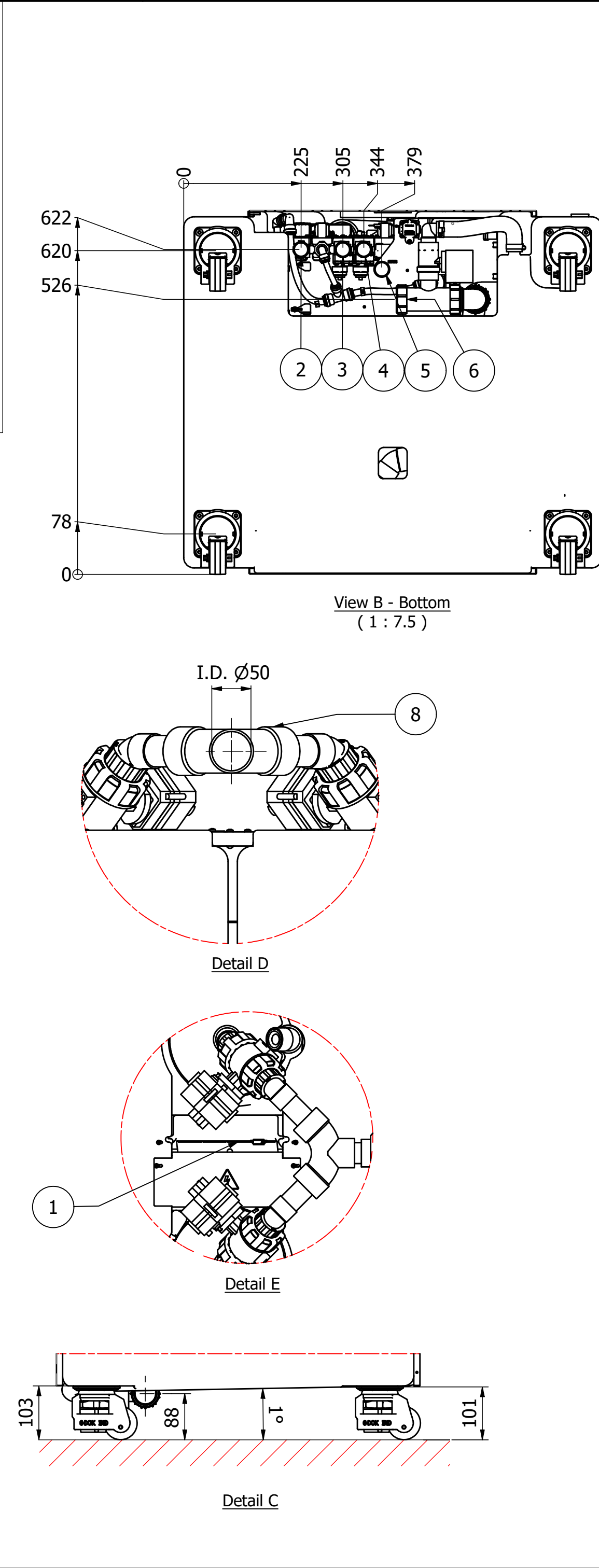
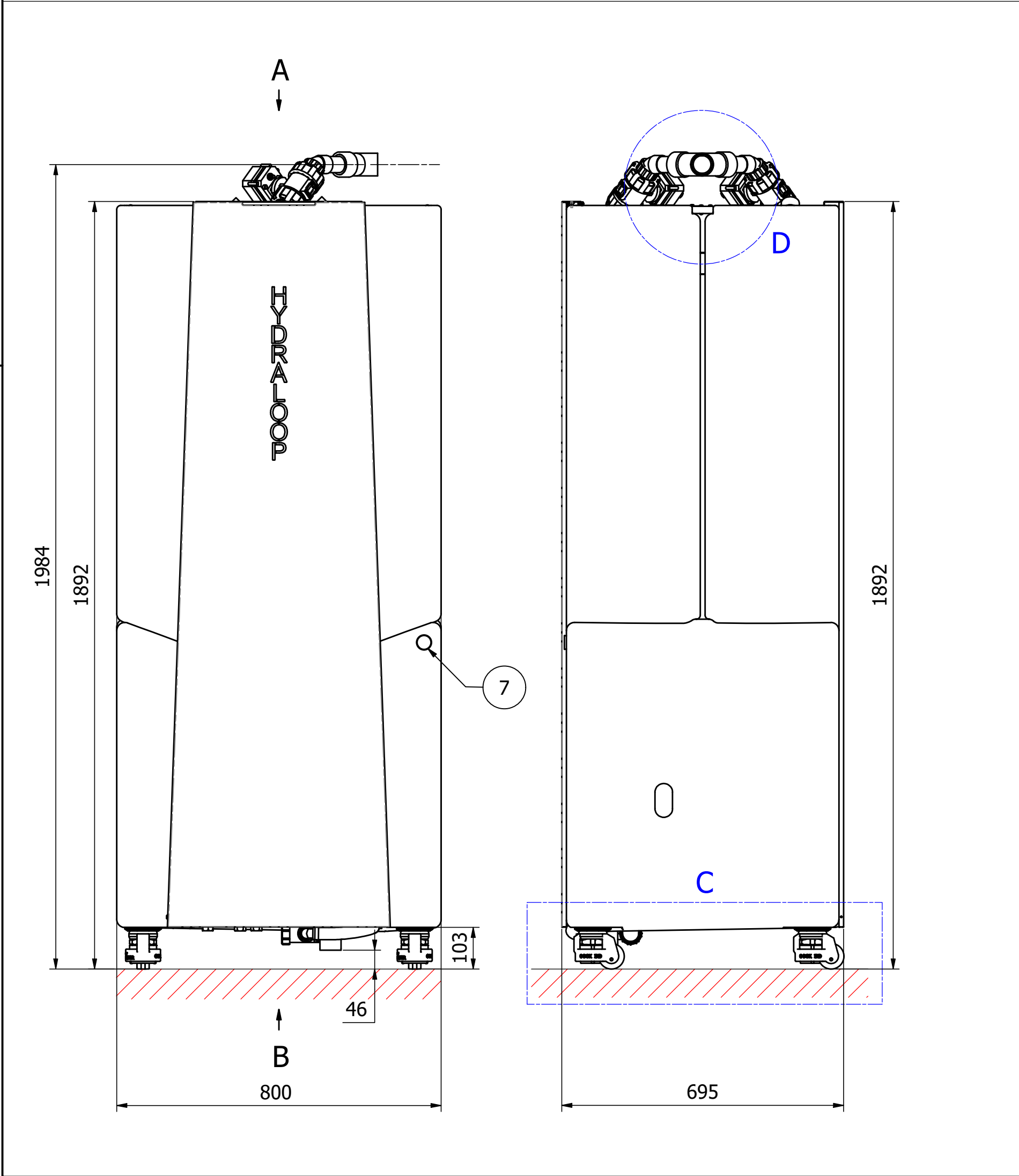



Visual status indications

White light: A white light indicates that there is a sufficient volume of reusable water for all uses.

Blue light: A blue light indicates that there is currently no reusable water available and backup water is being used for all purposes.

Blue white alternate light: A blue-white alternating light indicates that there is reusable water in the storage tank, but not enough for a full washing machine cycle.

Green light: A green light indicates that the Hydraloop device is in automatic cleaning mode.

Purple light: A purple light indicates that the Hydraloop device is detecting that the washing machine is in operation.

Orange light: An orange light indicates that your Hydraloop device is currently not treating greywater and has automatically switched over to backup water.

Since your device is monitored 24/7, your Hydraloop installer knows about this. If the status light does not change after 24 hours, please contact Hydraloop support in your Hydraloop app.

Red light: A red light on the LED panel can indicate two things.

1. The Hydraloop device detects an issue with your toilets or washing machine.
2. There is an issue with the Hydraloop device, and no water can be distributed to the toilets and washing machines. In the event of a red light, please open your Hydraloop app and contact Hydraloop directly.

Audible status indications

High water level: Buzzer alarm: 2 beeps every minute, visual alarm: 2 pulses every minute

Air pump: Buzzer alarm: 3 beeps every minute, visual alarm: 3 pulses every minute

UV lamp: Buzzer alarm: 4 beeps every minute, visual alarm: 4 pulses every minute

Water storage tank re-disinfection

circulation: Buzzer alarm 5 beeps every minute, visual alarm: 5 pulses every minute

Water distribution pump: Buzzer alarm: 6 beeps every minute, visual alarm: 6 pulses every minute

If you need assistance, please call your Hydraloop installer or contact Hydraloop directly via support@hydraloop.com or the Hydraloop app.